

CITY COUNCIL AGENDA COVER-SHEET
--

From: Nancy Batchelder, City Recorder

- ☒ Regular Meeting Agenda Item ☐ Work Session Discussion Topic
- ☐ Add to agenda for _____ meeting.
 - ☐ Continue this item until _____.
 - ☐ Item dismissed.

DATE: July 13, 2011

Title: Request for Street Name in the Dwellings Development

Item: The developer and his agent have requested that the private road inside the development be named Village Lane. Because the name was not originally shown on the plat map, the County requires City Council approval.

The normal procedure for a new street name or a change in the name would be to survey all the property owners on that street. This was not necessary in this case because the roadway lies entirely within the boundaries of the development owned by the person making the request.

The Public Works & Streets Commission voted at the July 12, 2011 to recommend that City Council approve the name requested.

Note: The original request was for Village Drive, and that is the name the Public Works & Streets Commission voted on. In checking the County Code I realized that because the road is less than 1000' feet must be either a lane or a terrace. I contacted the agent and she said to go with Village Lane.

Related Goal:

Reference And Review Material:

Budget Impact:

Additional Information:

Attachments: Request and area maps

*Sam Williamson, developer of “The Dwellings” subdivision, has authorized me to request a street name change for the street serving his property off of Shellmidden. The name request is “**Village Drive**”. I’ve attached the site plan and plat map for clarity.*

Please consider this proposal of Village Drive at next week’s Public Works and Streets Commission for their recommendation to City Council

Thank you,

Sandy Cell: 541-961-1522

Sandra J. George, Broker, GRI Windermere West Coast Properties

Office: 541-265-5455/ 888-814-2963/ Fax: 541-265-5737

Email: sandy@sandygeorge.net/ WEB: www.sandygeorge.net

THIS MAP WAS PREPARED FOR
ASSESSMENT PURPOSE ONLY

NE1/4 NE1/4 SEC. 34 T.14S. R.12W. W.M.
LINCOLN COUNTY

1" = 100'

14 12 34AA
YACHATS

CANCELLED NO.
1000
1400
1602
1802

SEE MAP 14 12 27DD

SEE MAP 14 12 27DD

PACIFIC
OCEAN

SEE MAP 14 12 34
OCEAN

YACHATS

SEE MAP 14 12 34

SEE
SUPPLEMENTAL
MAP NO. 1

302

328

302

302

328

SEE MAP 14 12 34AD

14 12 34AA
YACHATS

MADE 17/09/1999 DOR
LAST REVISED 01/27/2010 SFB

SEE MAP 14 12 34AC

SEE MAP 14 12

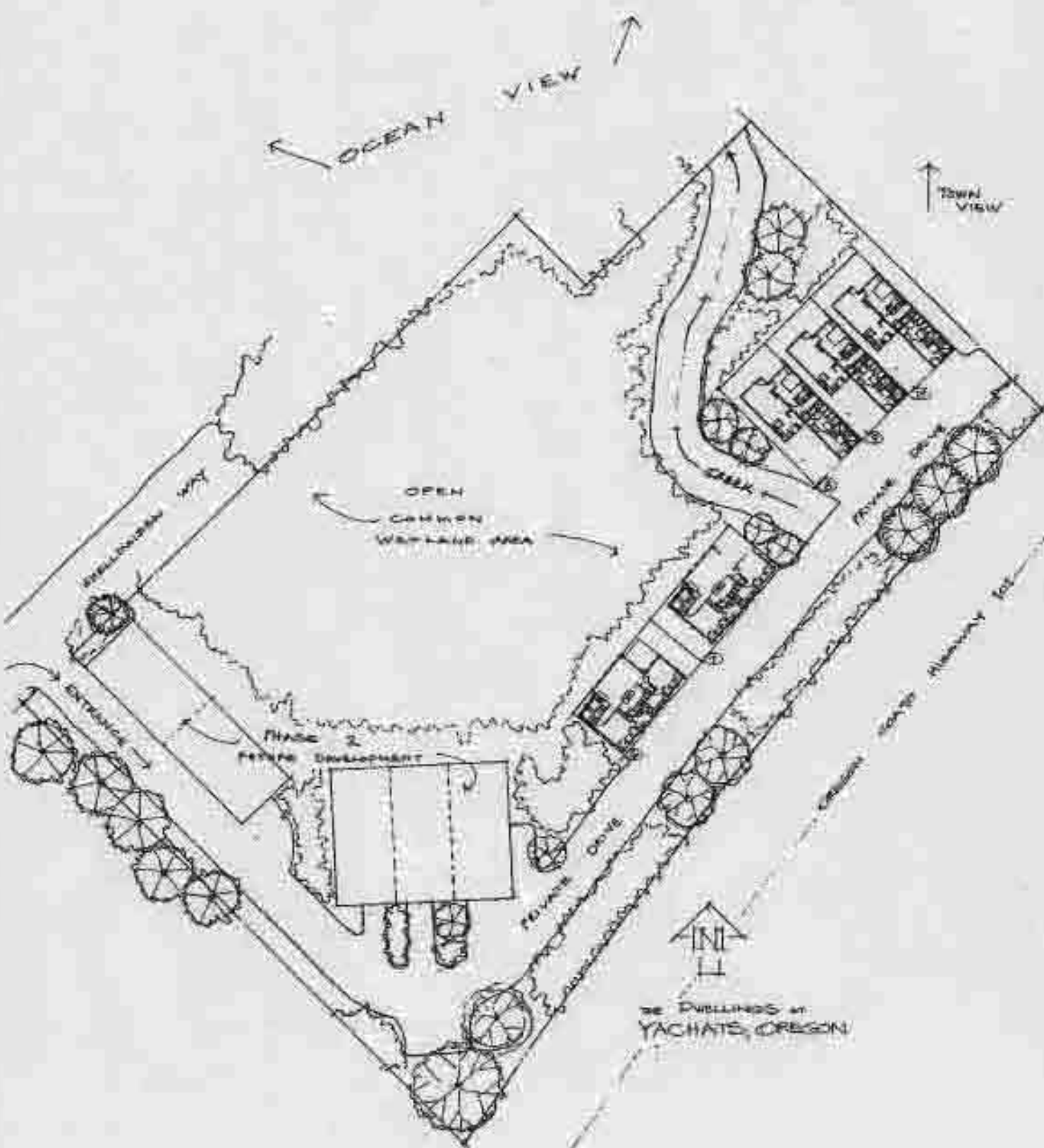

OCEAN VIEW

TOWN VIEW

OPEN
COMMON
WETLAND AREA

HOLLANDS WAY

ENTRANCE

PHASE 2
FUTURE DEVELOPMENT

DRIVE

DRIVE

OCEAN STATE HIGHWAY 101

DRIVE DRIVE



THE DUBLINGS AT
YACHTS, OREGON